

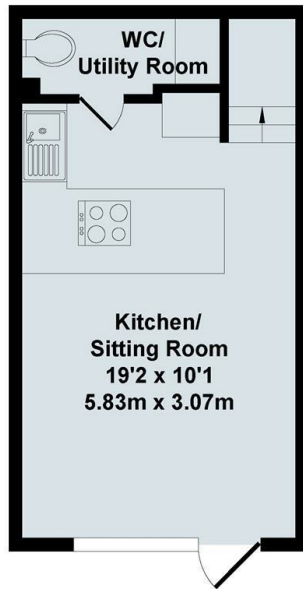

## The Shoebox, 95C High Street, Wheatley, Oxford, Oxfordshire, £1,250 PCM - 8th July 2026.

- Unique One Bedroom Detached House
- Available Fully Furnished
- Open Plan Living/Kitchen Area
- Integrated Appliances & Washing Machine
- Electric Heating
- On street parking with restrictions
- Mains electricity and water
- EPC Rating C
- Council Tax Band C



Ground Floor

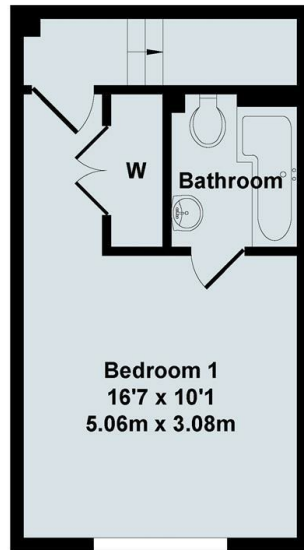

First Floor



Total Approx. Floor Area 385 Sq.Ft. (35.80 Sq.M.)  
 All items illustrated on this plan are included in the "Total Approx Floor Area"

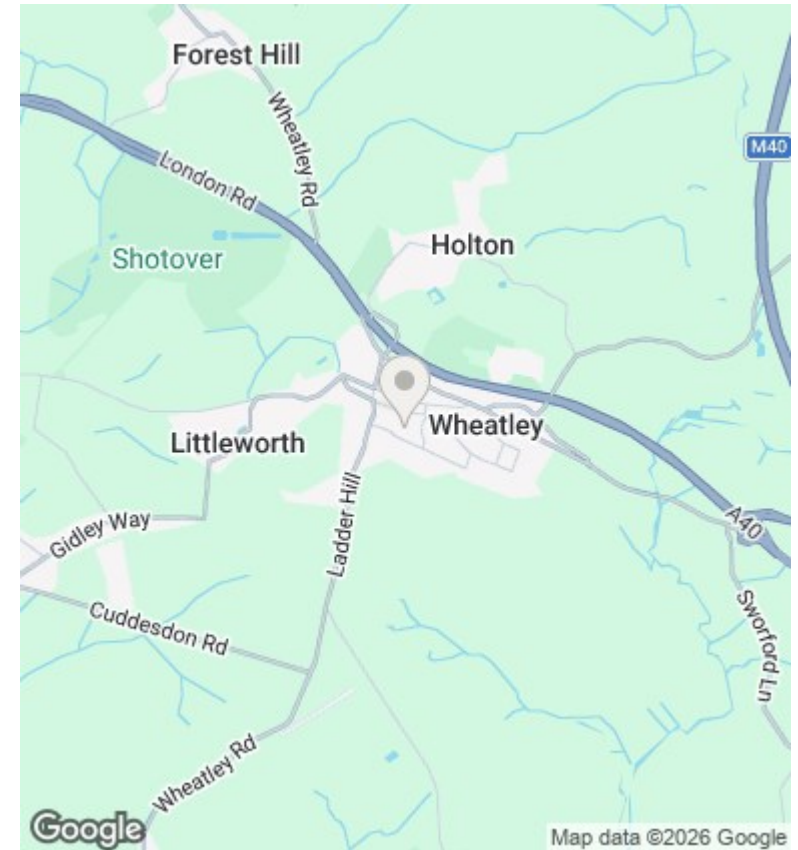

Directions

Viewings

Viewings by arrangement only. Call 01865 515900 to make an appointment.

Council Tax Band

C

EPC Rating:

C

Energy Efficiency Rating		Current	Potential
<i>Very energy efficient - lower running costs</i>			
(92 plus)	A		96
(81-91)	B		
(69-80)	C	75	
(55-68)	D		
(39-54)	E		
(21-38)	F		
(1-20)	G		
<i>Not energy efficient - higher running costs</i>			
<b>England &amp; Wales</b>		EU Directive 2002/91/EC	